

THREE BEDROOM, THREE BATHROOM – ASHWELL APARTMENTS

Floorplan AC2

This three-bedroom, three-bathroom floorplan features an open layout, floor-to-ceiling windows with south eastern views, feature splash-back tiling in the kitchen, built-in additional storage, underfloor heating throughout and a main living area that opens onto a large private balcony overlooking Elephant Park.

This floorplan offers a selection of furnished and unfurnished apartments.

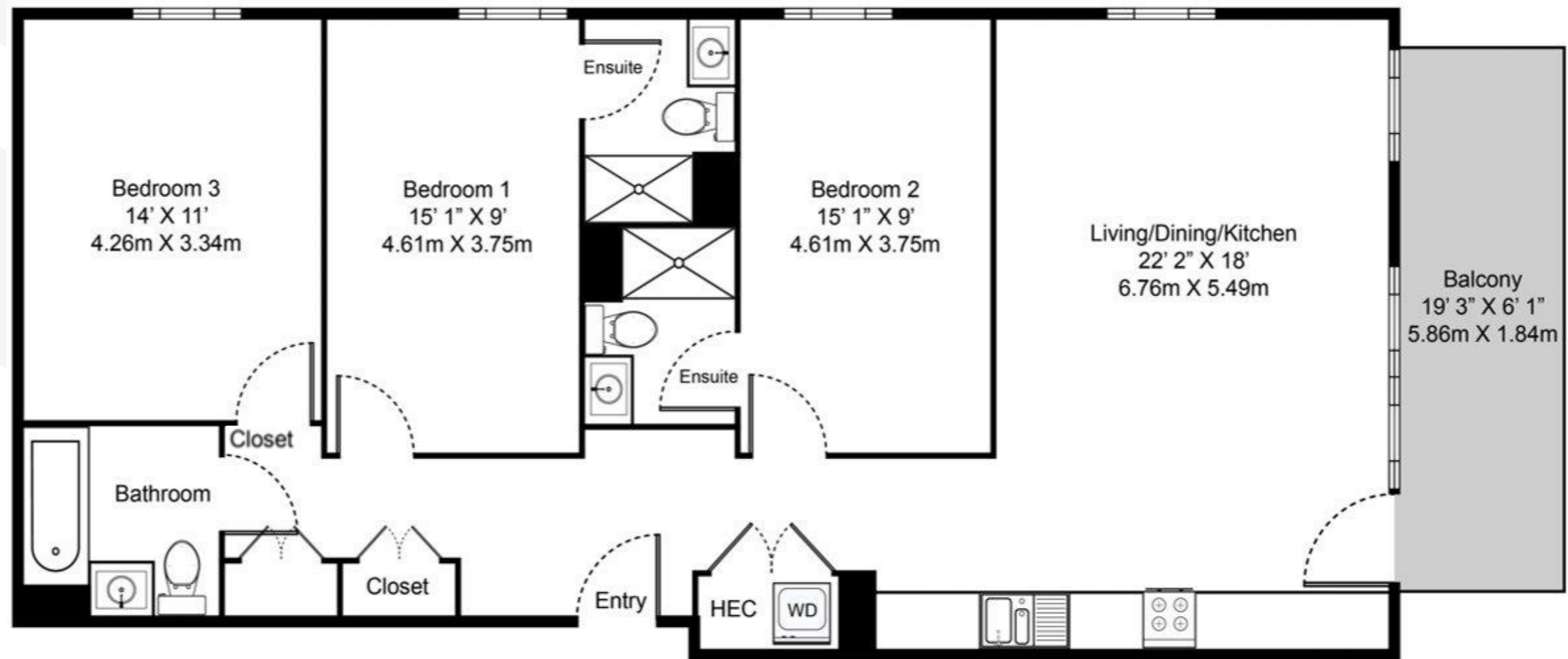

020 7182 9300

parkcentralwest@livingbylendlease.com

For illustrative purposes only. Exact measurements and dimensions may vary by unit. See your leasing associate for specific apartment information.

PCW | AC2 – March 2021

Internal Space: 1,056 sqft/98.1 sqm
External Space: 113 sqft/10.5 sqm

