

ONE BEDROOM, ONE BATHROOM – ASHWELL APARTMENTS

Floorplan AA2

This one-of-a-kind one-bedroom, one-bathroom seventh floor apartment features an open floor layout with floor-to-ceiling windows, underfloor heating throughout, feature splash-back tiling in the kitchen and a private outdoor terrace with eastern views.

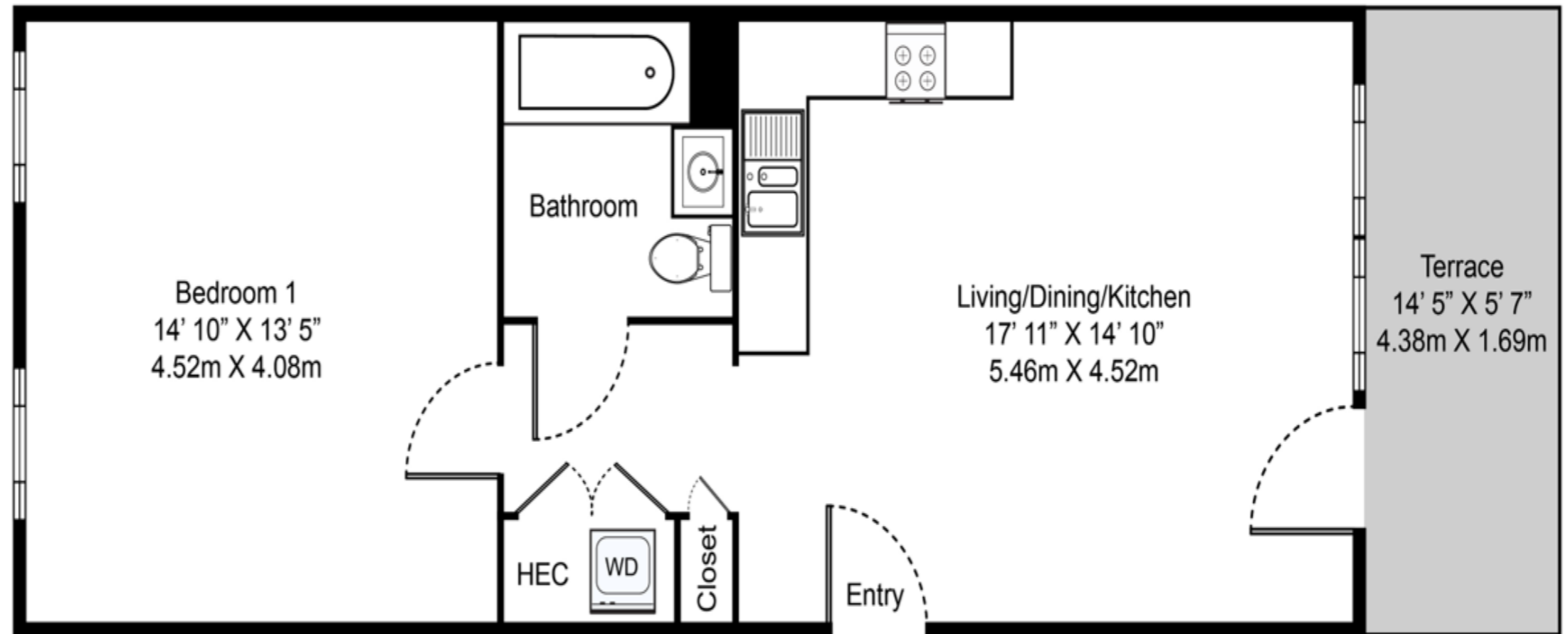

020 7182 9300

parkcentralwest@livingbylendlease.com

For illustrative purposes only. Exact measurements and dimensions may vary by unit. See your leasing associate for specific apartment information.

PCW | AA2 – March 2021

Internal Space: 576 sqft/53.5 sqm
External Space: 78 sqft/7.2 sqm

